

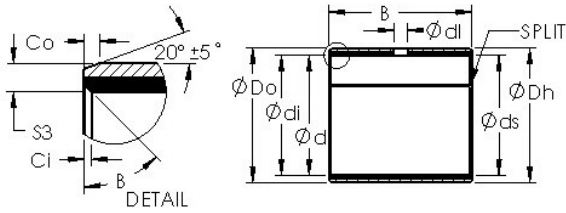

Tolamentos do Brasil Ltda



AST AST40 28080 plain bearings

Bearing No. AST40 28080

Bore Diameter	280 mm
Outer Diameter	285 mm
Bearing Type	straight
Shaft Dia., Nominal (d)	280.0000
Shaft Size (ds) - 280 -0 / -0.081	280 0 / 0.081
Housing Bore Dia. (Dh)	285 +0.052 / +0
Bearing Outside Diameter, Nominal(Do)	285.000
Bearing Outside Diameter Tolerance (Do tol.)	285.26 / 285.17
Bearing Bore after Mounting (di)	280.222 / 280.07
Average Clearance (Cd)	0.1870
Wall Thickness (S3)	2.465
Bearing Length, Nominal (B)	80.000
Bearing Length Tolerance (B tol.) - +0 / -0.40	+0 / 0.40
OD Chamfer Length (Co)	1.800
ID Chamfer Angle (B deg.)	45
ID Chamfer Length (Ci)	0.600
Material	Steel shell with PTFE / Polymer Fiber lining

AST40 28080 Bearing 2D drawings and 3D CAD models